

# Soils Map

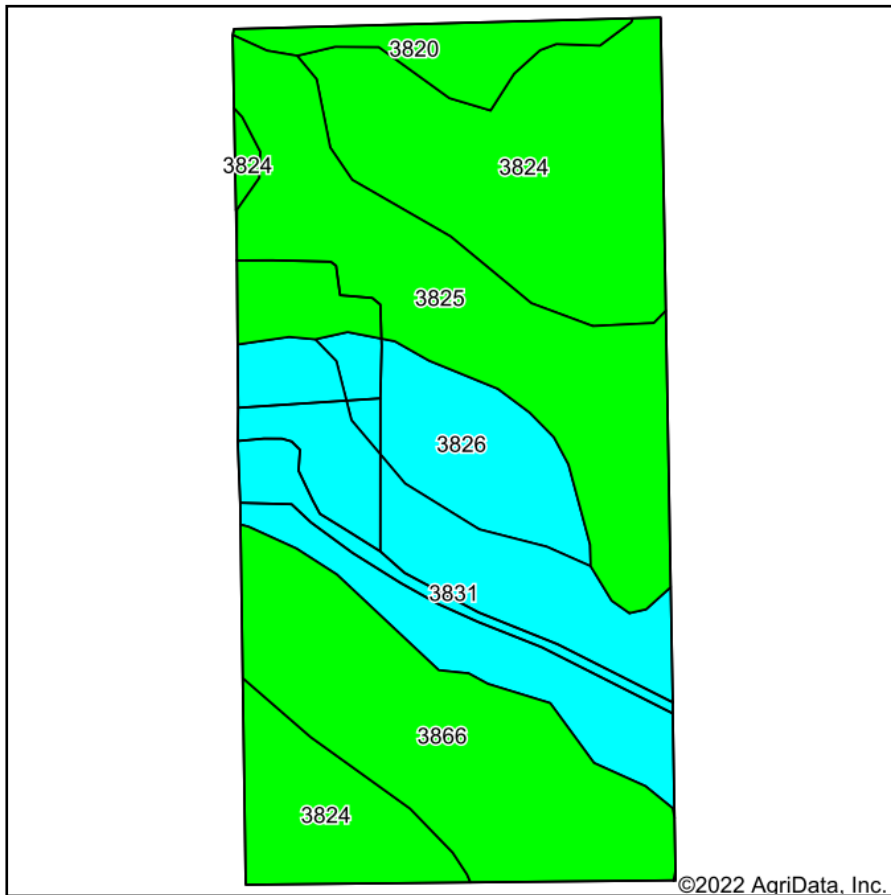

Soils data provided by USDA and NRCS.

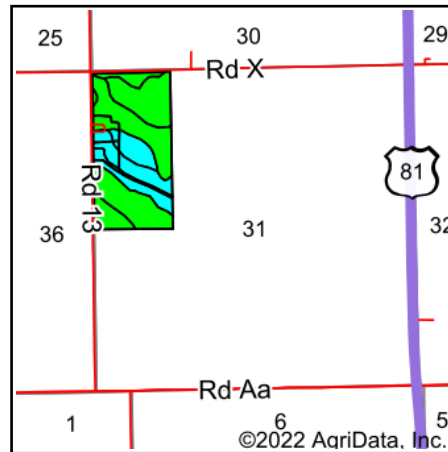

State: **Nebraska**  
 County: **Fillmore**  
 Location: **31-5N-2W**  
 Township: **Belle Prairie**  
 Acres: **76.17**  
 Date: **10/21/2022**



Area Symbol: NE059, Soil Area Version: 20

Code	Soil Description	Acres	Percent of field	Non-Irr Class Legend	Non-Irr Class *c	Irr Class *c	SRPG	*n NCCPI Soybeans
3824	Crete silt loam, 0 to 1 percent slopes	19.88	26.1%		Ils	Ils	70	64
3825	Crete silt loam, 1 to 3 percent slopes	16.93	22.2%		Ile	Ile	68	63
3831	Crete silty clay loam, 3 to 7 percent slopes, eroded	15.73	20.7%		IIIe	IIIe	67	56
3866	Hastings silt loam, 1 to 3 percent slopes	14.32	18.8%		Ile	Ile	74	68
3826	Crete silt loam, 3 to 7 percent slopes	6.29	8.3%		IIIe	IIIe	66	63
3820	Butler silt loam, 0 to 1 percent slopes	3.02	4.0%		IIw	IIw	74	61
<b>Weighted Average</b>					<b>2.29</b>	<b>2.29</b>	<b>69.5</b>	<b>*n 62.7</b>

\*n: The aggregation method is "Weighted Average using all components"

\*c: Using Capabilities Class Dominant Condition Aggregation Method

Soils data provided by USDA and NRCS.