

Soils Map

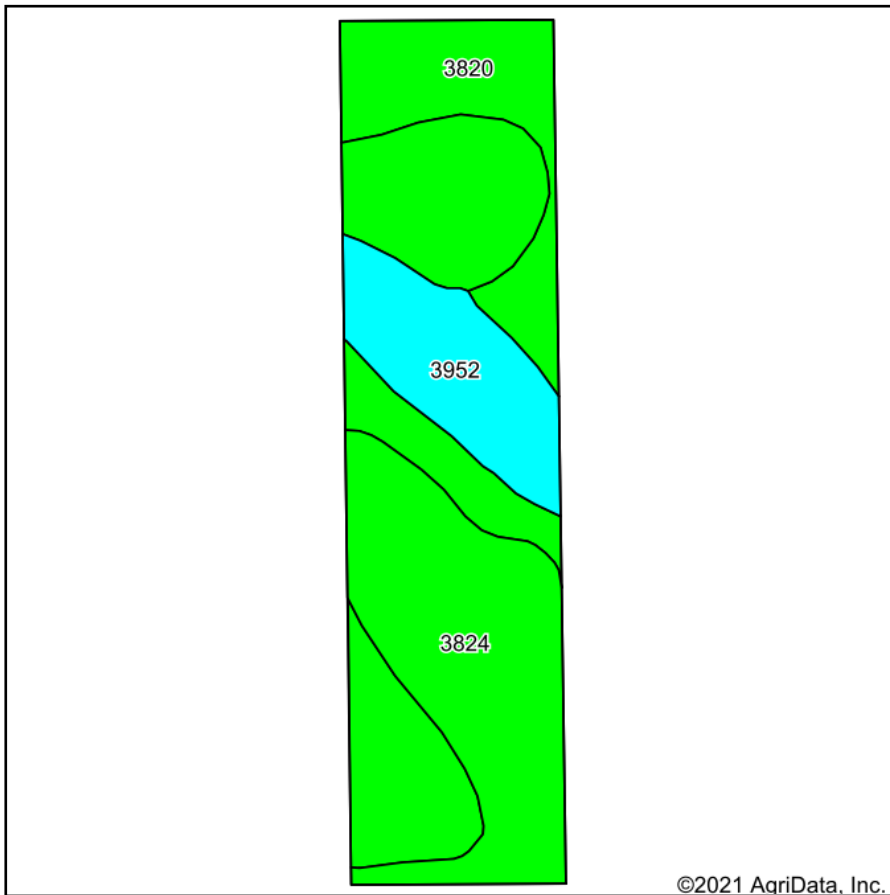

Soils data provided by USDA and NRCS.

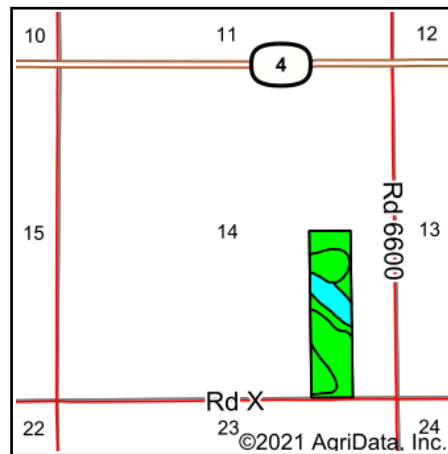

State: **Nebraska**
 County: **Thayer**
 Location: **14-4N-2W**
 Township: **Bruning**
 Acres: **39.36**
 Date: **10/4/2021**



Area Symbol: NE169, Soil Area Version: 17

Code	Soil Description	Acres	Percent of field	Non-Irr Class Legend	Non-Irr Class *c	Irr Class *c	SRPG	*n NCCPI Soybeans
3824	Crete silt loam, 0 to 1 percent slopes	19.13	48.6%		Ils	Ils	71	64
3820	Butler silt loam, 0 to 1 percent slopes	13.87	35.2%		IIw	IIw	74	60
3952	Fillmore silt loam, frequently ponded	6.36	16.2%		IIIw	IVw	49	40
Weighted Average							68.5	*n 58.7

*n: The aggregation method is "Weighted Average using all components"

*c: Using Capabilities Class Dominant Condition Aggregation Method

Soils data provided by USDA and NRCS.