

## Soils Map

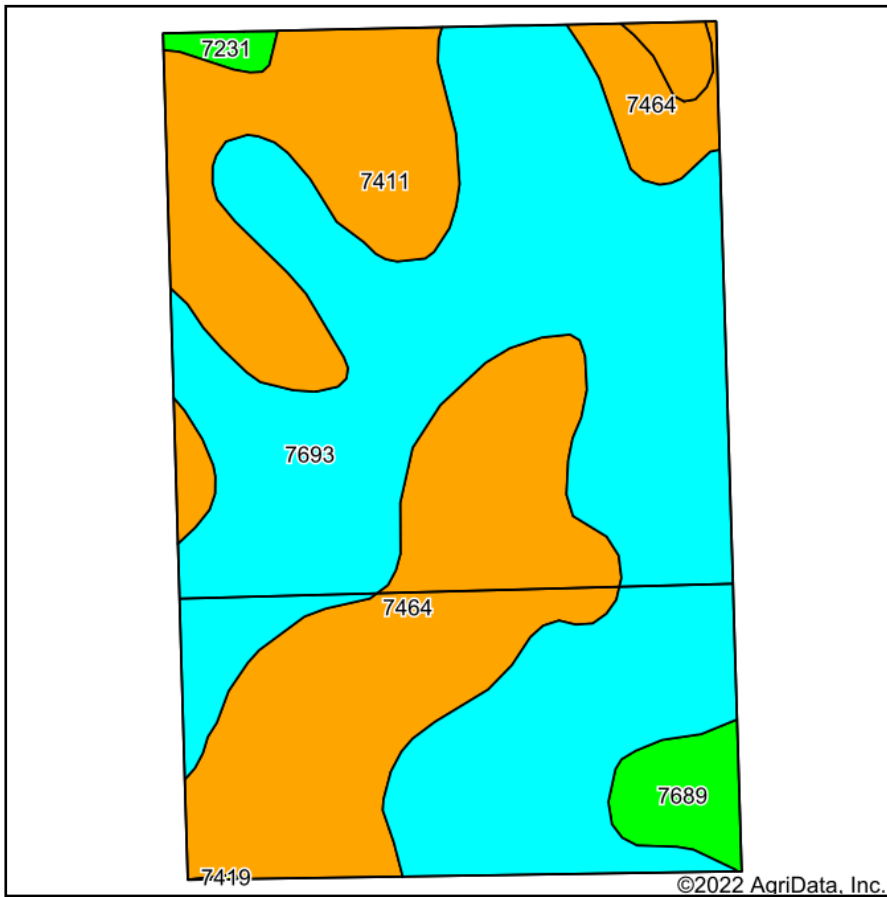

Soils data provided by USDA and NRCS.

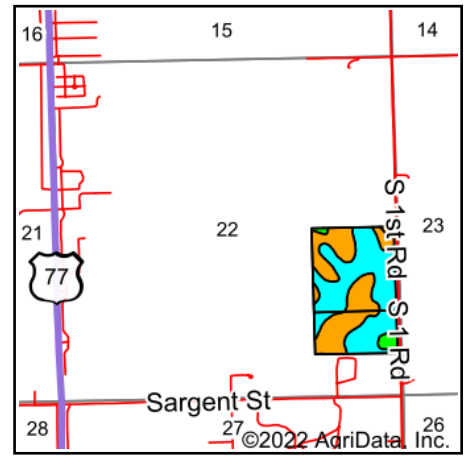

State: **Nebraska**  
County: **Gage**  
Location: **22-4N-6E**  
Township: **Midland**  
Acres: **58.14**  
Date: **8/4/2022**

Maps Provided By:



Area Symbol: NE067, Soil Area Version: 24

Code	Soil Description	Acres	Percent of field	Non-Irr Class Legend	Non-Irr Class *c	Irr Class *c	SRPG	Alfalfa hay Tons	Alfalfa hay Irrigated Tons	Corn Bu	Corn Irrigated Bu	Grain sorghum Bu	Grain sorghum Irrigated Bu	Soybeans Bu	Soybeans Irrigated Bu	Winter wheat Bu	*n NO Soybe
7693	Wymore silty clay loam, 2 to 6 percent slopes	32.23	55.4%		IIle	IIle	69										
7464	Otoe silty clay loam, 6 to 11 percent slopes, eroded	14.74	25.4%		IVe		66										
7411	Cortland-Malmo complex, 6 to 11 percent slopes, eroded	9.01	15.5%		IVe	IVe	54	4	6	81	133	82	116	31	46	39	
7689	Wymore silty clay loam, 0 to 2 percent slopes	1.74	3.0%		IIls	IIls	72										
7231	Judson silt loam, 2 to 6 percent slopes	0.42	0.7%		IIle		80										
Weighted Average					3.37	*-	66.1	0.6	0.9	12.6	20.6	12.7	18	4.8	7.1	6	*

\*n: The aggregation method is "Weighted Average using all components"

\*c: Using Capabilities Class Dominant Condition Aggregation Method

\* - Irr Class weighted average cannot be calculated on the current soils data due to missing data.

Soils data provided by USDA and NRCS.